

Industry Leading Curb Seal Technology

It's not just any Skylight,
it's a **VELUX**!

VELUX's **3 patented layers** of water protection works seamlessly with a variety of roofing material, shedding water naturally without the use of "wet seals" to provide the most durable protection against the Canadian climate. At VELUX our products endure rigorous testing to ensure quality and performance in every box.



The No Leak Skylight™

• No Leak Promise • No Worries



1



2

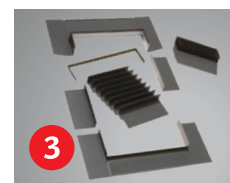

3

- 1 Gasket:** The pre-attached curb gasket provides an **airtight and caulking-free seal** between the site-built curb and the skylight.
- 2 Adhesive Underlayment:** The adhesive underlayment provides **secondary water protection** throughout the harshest weather conditions.
- 3 Flashing:** Easy to install engineered flashing is the **primary water protection**.

Features on all Curb Mounted Skylights

- Superior corner key design eliminates exposed fasteners for improved weather performance and aesthetics.
- Venting models have interior finished white frame to sit on site-built curb.
- Exterior fastening eliminates the need to enter the home during installation.

The **No Leak** Curb Mounted Skylights

VCS

Solar Powered
"Fresh-air" Skylight



Simple remote

- No wiring required; skylight is fully functional regardless of the time of day.
- Standard with insect screen and simple remote control.
- Acoustic rain sensor to close skylight in inclement weather.
- Superior corner key design eliminates exposed fasteners for improved weather performance and aesthetics.
- Closed cell foam gasket seals the skylight to the curb preventing water and air infiltration. No need for wet seals i.e. caulking.
- **VELUX recommends a 5° slope for water drainage when installing on a flat roof.**

VCE

Electric Venting
"Fresh-air" Skylight



Simple remote

- Includes integrated motor and control system with 20' of standard electrical cable.
- Standard with insect screen and simple remote control.
- Rain sensors to close skylight at first drop of rain.
- Superior corner key design eliminates exposed fasteners for improved weather performance and aesthetics.
- Closed cell foam gasket seals the skylight to the curb preventing water and air infiltration. No need for wet seals i.e. caulking.
- **VELUX recommends a 5° slope for water drainage when installing on a flat roof.**

VCM

Manual Venting
"Fresh-air" Skylight



Crank handle included

- Standard with insect screen, operator hook and crank handle.
- Superior corner key design eliminates exposed fasteners for improved weather performance and aesthetics.
- Closed cell foam gasket seals the skylight to the curb preventing water and air infiltration. No need for wet seals i.e. caulking.
- **VELUX recommends a 5° slope for water drainage when installing on a flat roof.**

FCM

Fixed Curb Skylight



- Ideal for visually expanding areas and delivering abundant natural light.
- Dual functioning condensation gasket system that seals skylight to the curb preventing water and air infiltration. No need for wet seals i.e. caulking.
- Condensation weepage system on all four corners.
- **VELUX recommends a 5° slope for water drainage when installing on a flat roof.**

Sizes

	1430	1446	2222	2230	2234	2246	2270	3030	3046	3434	3446	4622	4646	3055	3072	4672
0° - 60° 0:12 - 20:12																
Rough opening (W" x H")	14 1/2 x 30 1/2	14 1/2 x 46 1/2	22 1/2 x 22 1/2	22 1/2 x 30 1/2	22 1/2 x 34 1/2	22 1/2 x 46 1/2	22 1/2 x 70 1/2	30 1/2 x 30 1/2	30 1/2 x 46 1/2	34 1/2 x 34 1/2	34 1/2 x 46 1/2	46 1/2 x 22 1/2	46 1/2 x 46 1/2	30 1/2 x 54 3/4	30 1/2 x 72 1/4	46 1/2 x 72 1/4
Outside curb (W" x H")	17 1/2 x 33 1/2	17 1/2 x 49 1/2	25 1/2 x 25 1/2	25 1/2 x 33 1/2	25 1/2 x 37 1/2	25 1/2 x 49 1/2	25 1/2 x 73 1/2	33 1/2 x 33 1/2	33 1/2 x 49 1/2	37 1/2 x 37 1/2	37 1/2 x 49 1/2	49 1/2 x 25 1/2	49 1/2 x 49 1/2	33 1/2 x 57 3/4	33 1/2 x 75 1/4	49 1/2 x 75 1/4
Maximum Skylight Clearance (W" x H")	18 5/8 x 34 5/8	18 5/8 x 50 5/8	26 5/8 x 26 5/8	26 5/8 x 34 5/8	26 5/8 x 38 5/8	26 5/8 x 50 5/8	26 5/8 x 74 5/8	34 5/8 x 34 5/8	34 5/8 x 50 5/8	38 5/8 x 38 5/8	38 5/8 x 50 5/8	50 5/8 x 26 5/8	50 5/8 x 50 5/8	34 3/4 x 59	34 3/4 x 76 1/2	50 3/4 x 76 1/2

• All models • VCS & FCM models only • FCM models only

Custom sizes available to a maximum of 50 3/4" x 76 1/2", see page 28 for sizes. Call VELUX for details.

VELUX Recommended

velux.ca
1 800-888-3589

